

# debbie fortune

ESTATE AGENTS

## Notting Hill Way, Lower Weare

Guide Price £595,000

🛏 4 🍷 2 🛋 2



**BEAUTIFUL BARN CONVERSION** with excellent proportions and four bedrooms, this house enjoys countryside views, a large driveway and garaging



## Key Features

- Barn Conversion
- Two bathrooms
- Separate utility room
- Large mature garden
- Council Tax Band F
- Four double bedrooms
- Countryside views
- Large entrance hall
- Spacious driveway and garage
- EPC E

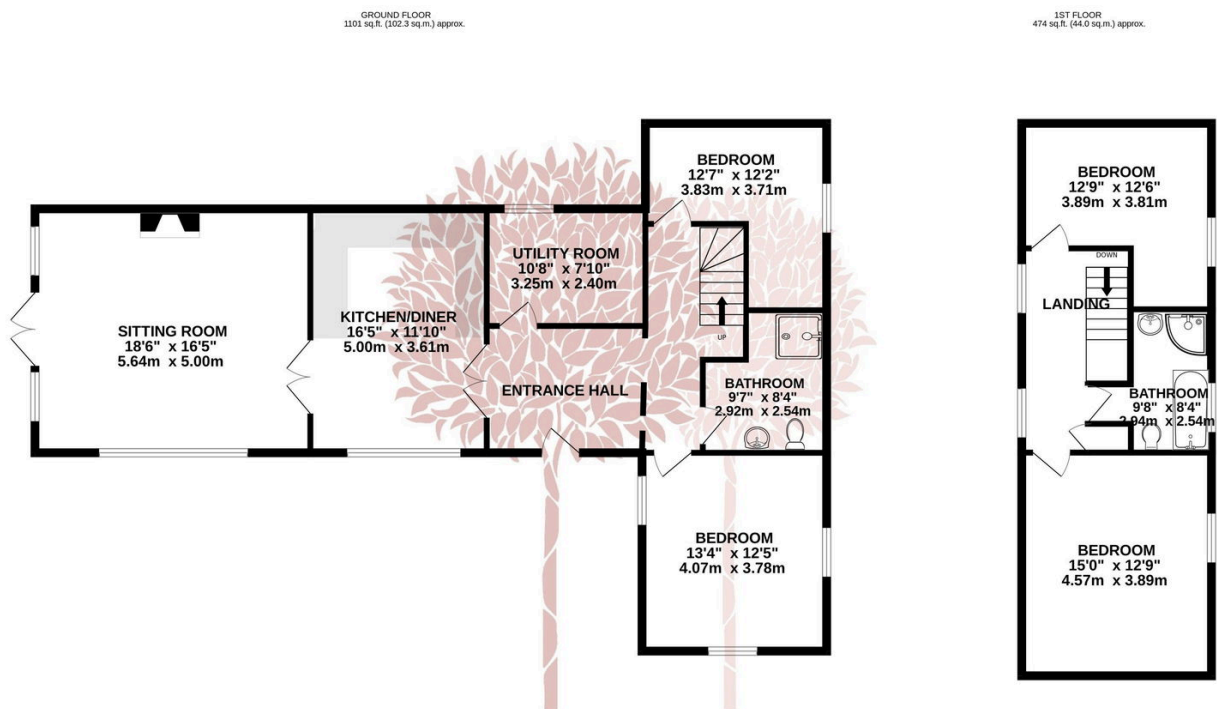

TOTAL FLOOR AREA: 1575 sq.ft. (146.3 sq.m.) approx.

Whilst every attempt has been made to ensure the accuracy of the floorplan contained here, measurements of doors, windows, rooms and any other items are approximate and no responsibility is taken for any error, omission or mis-statement. This plan is for illustrative purposes only and should be used as such by any prospective purchaser. The services, systems and appliances shown have not been tested and no guarantee as to their operability or efficiency can be given.

Made with Metropix ©2024

